

FLETCHER-TERRY PRODUCTS

INDUSTRIAL PRECISION GRADE CARBIDE WHEELS AND AXLES



Fletcher-Terry glass cutting wheels are machined from specially formulated micrograin tungsten carbide. Developed exclusively for The Fletcher-Terry Company, this fine particle carbide composition produces wheels of extraordinary strength and resilience. Wheels are ground and honed to precise tolerances through an exclusive Fletcher machining technique that results in regular and coarse grind finishes that guarantee superior scoring quality and consistency.

The carbide wheels are available in diameters from 0.140" (3.56mm) up to 0.625" (15.88mm), and with cutting angles from 88° to 120° for use in scoring tubing and rod. Precision ground carbide axles are available in outside diameters of 0.054" (1.37mm), 0.062" (1.57mm) and 0.116" (2.95mm), and in various lengths to suit your mounting needs. Our Sales and Service Technicians are available for further assistance in helping you select the right wheel for your application – whether it is a "Score and Snap" or Thermal Shock cutting process.

THE FLETCHER STANDARD CARBIDE WHEEL

Use full product number as shown, including ANGLE* and FINISH GRIND**
(Example: C245-055-88CR)

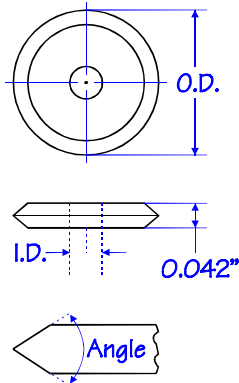

O.D.	I.D.	PRODUCT NUMBER
0.140" – 3.56mm	0.055" – 1.40mm	C140-055- <u>ANGLE*</u> <u>CR**</u> or <u>RG**</u>
0.175" – 4.44mm	0.055" – 1.40mm	C175-055- <u>ANGLE*</u> <u>CR**</u> or <u>RG**</u>
0.175" – 4.44mm	0.062" – 1.57mm	C175-062- <u>ANGLE*</u> <u>CR**</u> or <u>RG**</u>
0.196" – 5.00mm	0.051" – 1.30mm	C196-051- <u>ANGLE*</u> <u>CR**</u> or <u>RG**</u>
0.215" – 5.46mm	0.055" – 1.40mm	C215-055- <u>ANGLE*</u> <u>CR**</u> or <u>RG**</u>
0.215" – 5.46mm	0.062" – 1.57mm	C215-062- <u>ANGLE*</u> <u>CR**</u> or <u>RG**</u>
0.228" – 5.79mm	0.055" – 1.40mm	C228-055- <u>ANGLE*</u> <u>CR**</u> or <u>RG**</u>
0.245" – 6.22mm	0.055" – 1.40mm	C245-055- <u>ANGLE*</u> <u>CR**</u> or <u>RG**</u>
0.245" – 6.22mm	0.062" – 1.57mm	C245-062- <u>ANGLE*</u> <u>CR**</u> or <u>RG**</u>

*Standard Angles: 88°, 94°, 104°, 114°, 120°
 **Finish Grind: CR = Coarse, RG = Regular
 Standard Packaging: 20 wheels per vial
 Minimum Order: 60 wheels

THE FLETCHER "V500" WHEEL

Use full product number as shown, including ANGLE* and FINISH GRIND**
(Example: V500-118-88CR)

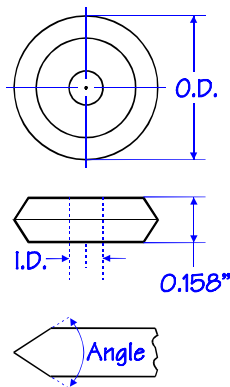

O.D.	I.D.	PRODUCT NUMBER
0.500" – 12.70mm	0.118" – 3.00mm	V500-118- <u>ANGLE*</u> <u>CR**</u> or <u>RG**</u>

*Standard Angles: 88°, 94°, 104°, 114°, 120°
 **Finish Grind: CR = Coarse, RG = Regular
 Standard Packaging: 1 wheel per pack
 Minimum Order: 25 wheels

FLETCHER-TERRY PRODUCTS

INDUSTRIAL PRECISION GRADE CARBIDE WHEELS AND AXLES



FLETCHER CARBIDE AXLES

Use full product number as shown, including O.D.* and A.L. (Length)**
 (Example: ACI - 054 - 201)
 (O.D.) (A.L.)

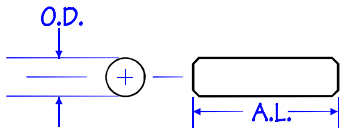

PRODUCT NUMBER	LENGTH
ACI-054-118	0.118" (2.99mm)
ACI-054-180	0.180" (4.57mm)
ACI-054-201	0.201" (5.10mm)
ACI-054-250	0.250" (6.35mm)
ACI-054-265	0.265" (6.73mm)
ACI-054-370	0.370" (9.39mm)
ACI-116-437	0.437" (11.10mm)
ACI-116-630	0.630" (16.00mm)

Note: Standard axles are supplied with blunt ends with the exception of ACI-054-370, ACI-062-370 and ACI-054-180, which are chamfered.

THE FLETCHER "DOUBLE ANGLE" WHEEL

Use full product number as shown.

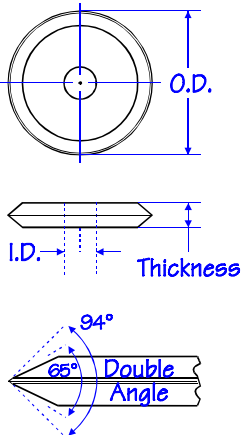

PRODUCT NUMBER	O.D.	I.D.	THICKNESS
C245-055-65/94CR	0.245" - 6.22mm	0.055" - 1.40mm	0.042" - 1.07mm
Standard Packaging: 20 wheels per vial			
Minimum Order: 60 wheels			
PRODUCT NUMBER	O.D.	I.D.	THICKNESS
V500-118-65/94CR	0.500" - 12.70mm	0.118" - 3.00mm	0.158" - 4.01mm
Standard Packaging: 1 wheel per pack			
Minimum Order: 25 wheels			

Other Products and Services:

- Carbide Wheel Units – Includes carbide wheel, axle and shell
- Carbide Wheel Holders and Inserts
- Carbide Wheel Rehonng Services
- Custom Wheel sizes – Special order only

Contact us today with your cutting product requirements.